

DEX™

A WIRELESS WORLD

USER INSTRUCTIONS

FM+DEX



WIDEX®
HIGH DEFINITION HEARING

PACKAGE CONTENTS

FM+DEX

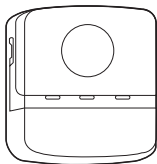

Neck loop antenna
(two lengths)

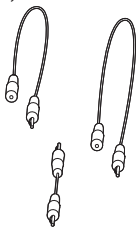

Click-on module

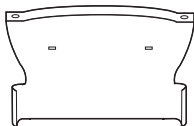

Charger



Jack-to-jack cable



Clip

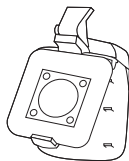

User instructions

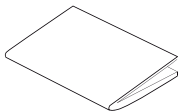

CONTENTS

YOUR NEW FM+DEX	6
Intended use	6
Description of device	7
FM+DEX OVERVIEW	8
LEDs	10
OPERATING RANGES	11
GETTING STARTED	12
Charging the battery	12
Preparing for Telecoil, FM or Audio	14
Antenna	22
TURNING ON THE DEVICE	29
ACOUSTIC INDICATORS	30
SELECTING INPUT SOURCE	31
VOLUME ADJUSTMENT	32
ROOM OFF	33
TURNING OFF THE DEVICE	34
TAMPER SWITCH	35
CARING FOR YOUR FM+DEX	36

WARNINGS	37
SAFETY WARNING.....	40
IN CASE OF MALFUNCTION....	41
REGULATORY INFORMATION	46
SYMBOLS.....	52

YOUR NEW FM+DEX

Your FM+DEX is part of the DEX™ family of assistive listening devices. These user instructions explain how the FM+DEX should be operated.



WARNING

This booklet contains important information and instructions. Please read this booklet carefully before you start using the device.

Intended use

The FM+DEX is a battery-powered device intended to transmit (or stream) signals to Widex hearing aids using the wireless Widex-Link technology; i.e. signals are received, altered and transmitted to the hearing aid.

Description of device

The FM+DEX is offered in order to support Widex hearing aids without DAI (direct audio input) or a telecoil.

When the FM module is attached, the user is able to receive FM signals.

In the same way, the device can substitute for a telecoil in hearing aids not fitted with a telecoil. The third input possibility is the line in, which can be used to stream music, etc., by connecting a computer or portable unit to the device.

The FM+DEX is worn on a neck loop antenna or attached directly to clothing using the included clip.

If you need help to identify the serial number (usually six or seven digits) on the product, please contact your hearing care professional.

FM+DEX OVERVIEW

1. On/Off
2. Input toggle key/Room off
3. Volume up/down
4. FM input LED
5. Audio input LED
6. T (telecoil) LED
7. Battery level indicator
8. Tamper switch
9. FM switch
10. FM connector (Europlug)
11. FM connector (SCOLA FLEX receiver)
12. Charge (mini USB socket)
13. Audio (line-in)
14. Cover

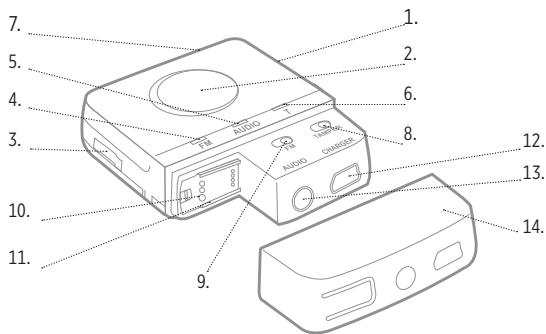

LEDS

Input indicators

Green light in any of the three input LEDs indicates that this input source has been chosen.

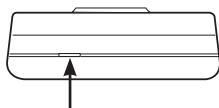
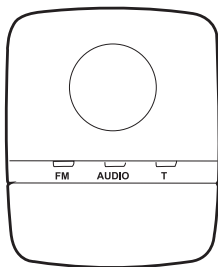

Battery indicator

Battery indicator

Battery low	red
Battery charging	orange
Battery fully charged, charging unit still connected	green

OPERATING RANGES

From FM+DEX to hearing aids	Up to 40 cm
From FM transmitter to FM+DEX	Up to 30 metres

GETTING STARTED

Charging the battery

The device uses a rechargeable battery that is charged through the mini USB connector. When fully charged, the battery has a capacity of approx. 10 hours of continuous use. The charger is available in four country versions. The version you have may therefore not look exactly as illustrated in this booklet.

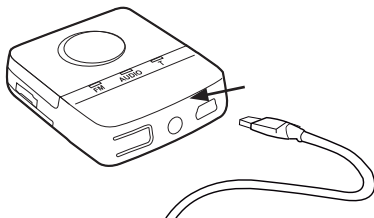

1. Connect the charger to the mini USB connector at the bottom of the FM+DEX.
2. Plug the charger into a wall socket.

It takes approximately 4 hours to charge the battery the first time. Recharging takes approx. 2 hours. The device cannot stream while recharging.



WARNING

Do not attempt to change the battery. Contact your hearing care professional.

Preparing for Telecoil, FM or Audio

The toggle key allows you to choose between three input sources, depending on whether you wish to receive Telecoil, FM or Audio signals. If you wish to use the Telecoil function, you just need to press the toggle key until the T LED is green. However, to prepare for FM or Audio reception, you need to do the following:

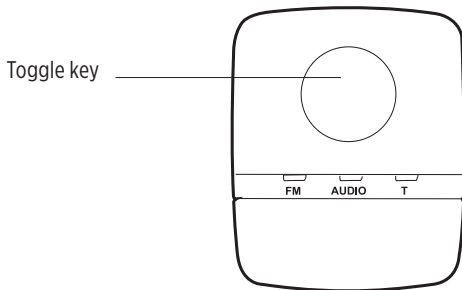

FM

If you wish to listen to an FM source, you will first need to connect the appropriate FM receiver module.

1. Remove the cover at the bottom of the device by pressing the sides of the cover.

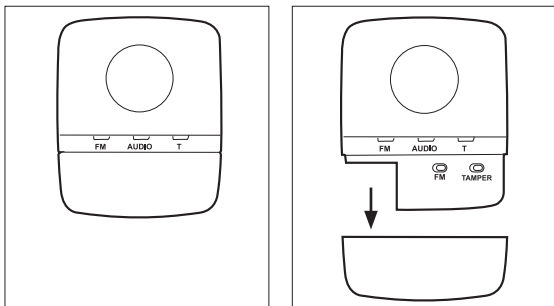

- 2a. If you have a Widex SCOLA FLEX receiver, slide it into place as shown. Set the receiver's mode switch in position 2 "FM+M".

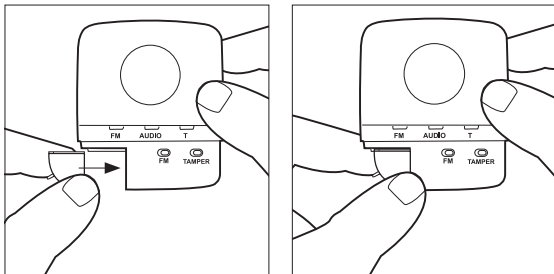

- 2b. Other compatible modules are connected to the device via a Europlug. Please be sure to turn and position the Europlug correctly, i.e. according to the thickness of the pins.

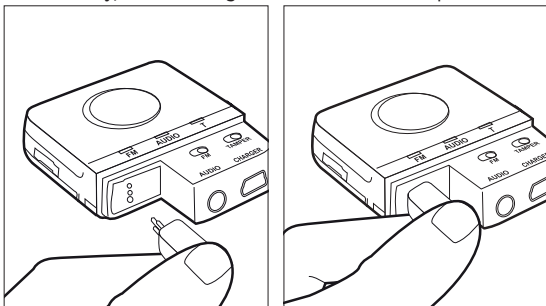

3. Turn the receiver module on.

- Slide the FM switch to the right if you are using a SCOLA FLEX interface or to the left if you are using a Europlug.

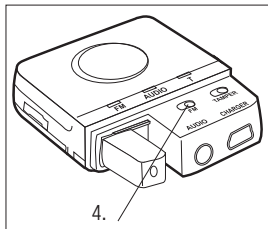

5. Attach the cover again.

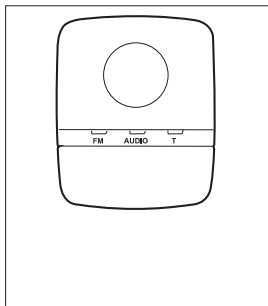
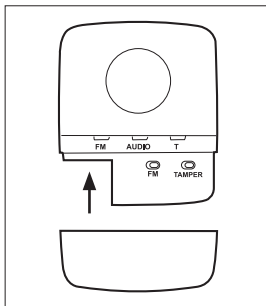

Pressing the “button” indicated by the arrow allows you to activate the scan button of the receiver module.

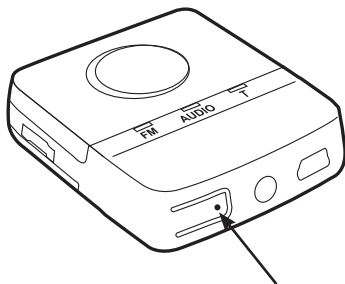

Audio

If you wish to listen to an audio source, plug the jack-to-jack cable provided into the Audio (line-in) socket. Connect the other end to the audio source.

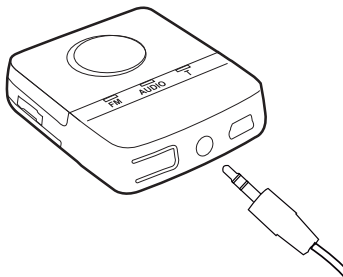

Antenna

The FM+DEX can be used with or without an external neck loop antenna.

Attaching the neck loop antenna

Assemble the two neck loop wires (if not already assembled) by connecting the male jack on the short wire to the female jack on the long wire. Then connect the jack connectors at the end of the neck loop wires to the holes in the click-on module.

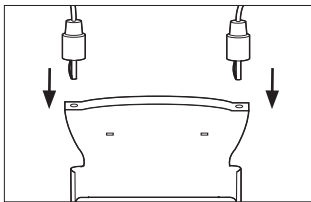
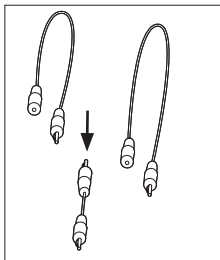

Then attach the assembled module to the device as illustrated.

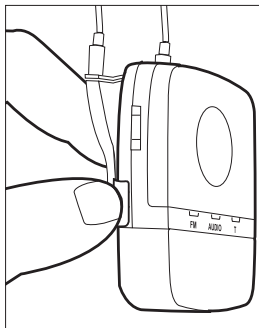
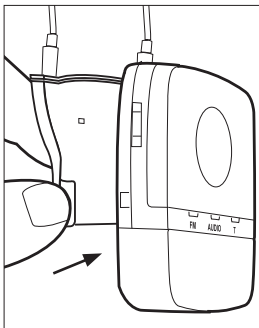

An alternative way of using the device is by attaching it to your clothes using the detachable clip. These first two illustrations show how to attach the clip to the device.

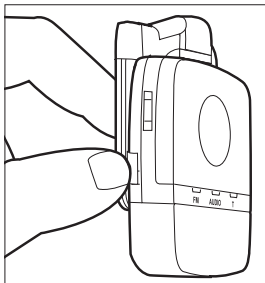
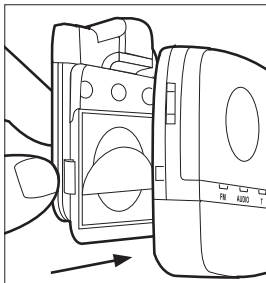

Pushing the clip upwards with two fingers allows you to turn the clip as required. Push it backwards to fix it in the desired position.

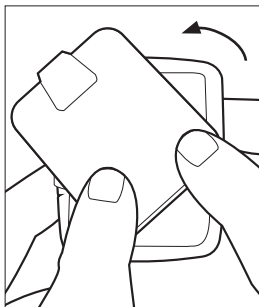
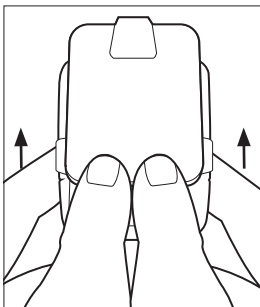

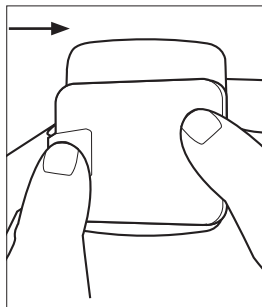
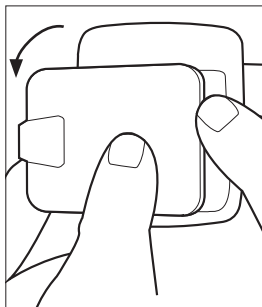

To open the clip, click the lock open, place it on your clothes and click it closed.

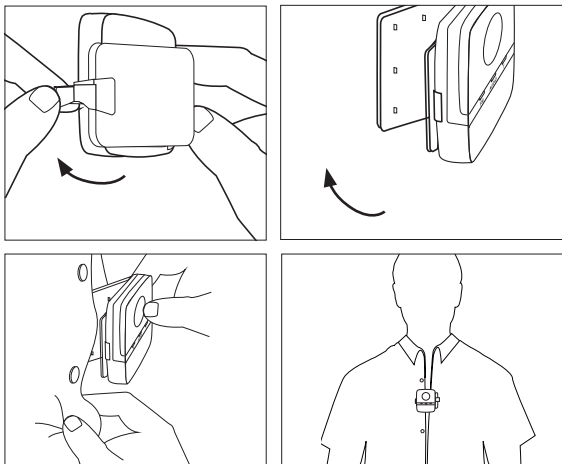



WARNING

Interference with active Implants

- In order to show caution, we advise to follow the guidelines recommended by manufacturers of defibrillators and pacemakers regarding use of mobile phones:
- If you wear an active implantable device keep the Wireless Hearing Aids and Hearing Aid Accessories such as wireless devices or communicators at least 15 cm away from the implant.
- If you experience any interference, do not use the hearing aids and/or hearing aid accessories and contact the manufacturer of the implant. Please note that interference can also be caused by power lines, electrostatic discharge, airport metal detectors etc.
- If you have an active brain implant, please contact the manufacturer of the implant for risk evaluation.

If you have an implantable device, we advise to keep magnets* at least 15 cm away from the implant. (*= can be specified as Autophone magnet, hearing instrument case, magnet in a tool, etc.)

TURNING ON THE DEVICE

Push the slide button on the right side upwards.

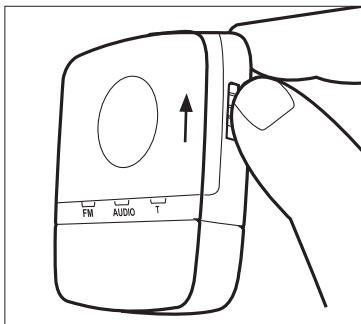

ACOUSTIC INDICATORS

When using any button/switch, a corresponding acoustic indicator will be presented in the hearing aids.

Turning the device on	Tone
Change of input source	Tone
Room on (start-up setting: On)	Tone
Volume adjustment	Tones

SELECTING INPUT SOURCE

The device starts up in the FM input setting. Using the toggle key you can change between the three input options: FM, AUDIO or T (telecoil). The current input source is indicated by a green light in the corresponding LED. Make sure that the desired source has been chosen.

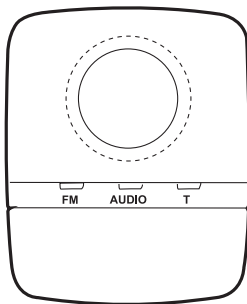

VOLUME ADJUSTMENT

The device starts up at the default volume level.

Use the volume control on the left side to adjust the volume up or down.

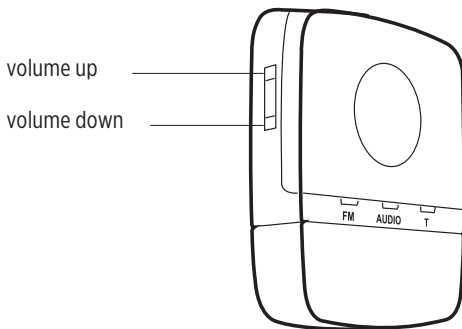

ROOM OFF

If you wish to listen to the input signal only, push the input toggle key and hold it in for more than one second. This will disable the hearing aid microphones. To deactivate this function again, push the input toggle key and hold it in again for more than one second.

TURNING OFF THE DEVICE

To turn the device off, push the slide button on the right side of the device downward.

When you turn the device off, it stops streaming and the hearing aids return to program 1 (usually the Master program).

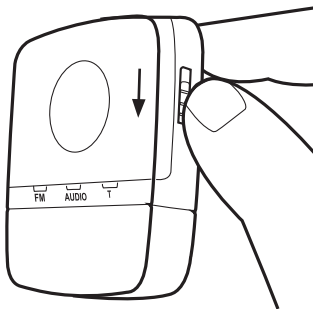

TAMPER SWITCH

The input toggle/room off key and volume control can be locked using the tamper switch. Slide the switch to the left to lock the functions, and to the right to unlock them. When the device is turned off and on again, it will start up in FM. The input toggle key will still be locked.

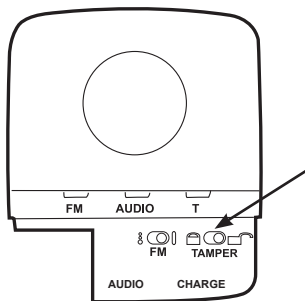

CARING FOR YOUR FM+DEX

The device is a valuable object and should be treated with care. Here are some things you can do to prolong the life of your device:



CAUTION

- Do not expose the device to extreme temperatures or high humidity.
- Do not immerse it in water or other liquids.
- Clean the device with a dry, soft cloth. Never clean it with acids, alcohol, strong detergents or other liquids.
- Avoid dropping the device.
- When the device is not in use, keep it in its case in a dry location out of reach of children and pets.

WARNINGS



WARNING

- Keep the FM+DEX and its parts and accessories out of reach of children and anyone else who might swallow parts of the device, or otherwise cause injury to themselves with these items. In case of ingestion, contact a physician immediately.
- **Do not carry your FM+DEX with you during X-rays, MRIs, CT or other medical treatments and scans, and never place your device in a microwave oven.** These are some of the types of radiation that can damage your device.
- Radiation from, for example, room surveillance equipment, burglar alarms and mobile phones is weaker and will not damage the device, but may create audible interference.
- Do not use the device on aircraft or in hospitals without permission.
- Do not use the device in mines or other areas with explosive gases.



CAUTION

- Never try to open or repair the device yourself. (This should only be done by authorized personnel.)
- Although the device has been designed to comply with the most stringent international electromagnetic compatibility standards, the possibility cannot be excluded that it may cause interference with other equipment, such as medical devices.



WARNING

Interference with active Implants

- In order to show caution, we advise to follow the guidelines recommended by manufacturers of defibrillators and pacemakers regarding use of mobile phones:
- If you wear an active implantable device keep the Wireless Hearing Aids and Hearing Aid Accessories such as wireless devices or communicators at least 15 cm away from the implant.
- If you experience any interference, do not use the hearing aids and/or hearing aid accessories and contact the manufacturer of the implant. Please note that interference can also be caused by power lines, electrostatic discharge, airport metal detectors etc.
- If you have an active brain implant, please contact the manufacturer of the implant for risk evaluation.

If you have an implantable device, we advise to keep magnets* at least 15 cm away from the implant. (*= can be specified as Autophone magnet, hearing instrument case, magnet in a tool, etc.)

SAFETY WARNING

This device is charged by an external power charger.

- Only connect a charger that is compatible with the FM+DEX.
- The charger must have an output rating of 5VDC, 500mA, and a mini USB connector.
- The charger input rating voltage and wall plug must be compatible with the AC wall outlet in your region.
- The charger must have the certification marks showing certification by a safety agency acceptable in your region.

Widex strongly recommends that you always use a charger unit that is supplied by your Widex Distributor to ensure safe and efficient use of your FM+DEX.

When the FM+DEX is connected to external mains-operated equipment like a PC, audio source or similar, this equipment must comply with IEC 60065, IEC 60950, IEC 60601-1 or equivalent safety standards.

IN CASE OF MALFUNCTION....

Problem	Possible cause	Solution
Your FM+DEX does not work	The device is not turned on	Turn it on
	The device is out of range	Move the device within range. See page 11.
No sound when listening to audio	FM+DEX is not within range of the hearing aids	Move the device within range
Temporary suspension of communication between hearing aids. Message: "Partner check"	FM+DEX is not within range of the hearing aids	Move the device within range

Problem	Possible cause	Solution
Streaming is interrupted	Interference with another device	Move one of the devices out of range of the other (2 m)
	The FM+DEX is out of range	Move the device within range. See page 11.

Problem	Possible cause	Solution
The input toggle key does not work	The FM+DEX is not turned on	Turn the FM+DEX on
	The battery is low	Charge the battery using the included charger
	The battery does not work	Contact your hearing care professional to have the battery replaced
	The charger is connected to the FM+DEX	Disconnect the charger when the FM+DEX has been charged
	Functions have been locked with tamper switch	Unlock

Problem	Possible cause	Solution
The charger is connected but does not charge (LEDs are not green)	The power supply to the FM+DEX has been interrupted	Check that the charger is properly connected to the FM+DEX mini USB socket and a wall socket, and that the wall socket is switched on
No streamed audio sound even though the audio input LED is green.	The cable between the sound source and the FM+DEX has been disconnected.	Connect the sound source to the FM+DEX
No streamed signals even though the telecoil (T) LED is green.	No teleloop signal	Place the FM+DEX in an area with teleloop signals

Problem	Possible cause	Solution
No streamed FM signals even though the FM input LED is green	No FM module is attached	Check that an FM module is attached
	The FM module or the FM transmitter is switched off	Check that the FM module and the FM transmitter are switched on and are set to the same channel
Battery level indicator is red	The battery is low	Charge the battery

REGULATORY INFORMATION

FCC ID: TTY-FMD

IC: 5676B-FMD

Federal Communications Commission Statement

This device complies with part 15 of the FCC Rules. Operation is subject to the following two conditions:

- (1) This device may not cause harmful interference, and
- (2) this device must accept any interference received, including interference that may cause undesired operation.

NOTE:

This equipment has been tested and found to comply with the limits for a Class B digital device, pursuant to part 15 of the FCC Rules. These limits are designed to provide reasonable protection against harmful interference in a residential installation. This equipment generates, uses and can radiate radio frequency energy and, if not installed and used in accordance with the instructions, may cause harmful interference to radio communications. However, there is no guarantee that interference will not occur in a particular installation. If this equipment does cause harmful interference to radio or television reception, which can be determined by turning the equipment off and on, the user is encouraged to try to correct the interference by one or more of the following measures:

- Reorient or relocate the receiving antenna.
- Increase the separation between the equipment and receiver.
- Connect the equipment into an outlet on a circuit different from that to which the receiver is connected.
- Consult the dealer or an experienced radio/TV technician for help.

NOTE:

This equipment complies with FCC radiation exposure limits set forth for an uncontrolled environment. This transmitter must not be co-located or operating in conjunction with any other antenna or transmitter.

Changes or modifications to the equipment not expressly approved by WSAUD A/S could void the user's authority to operate the equipment.

Industry Canada Statement / Déclaration d'industrie Canada

Under Industry Canada regulations, this radio transmitter may only operate using an antenna of a type and maximum (or lesser) gain approved for the transmitter by Industry Canada.

To reduce potential radio interference to other users, the antenna type and its gain should be so chosen that the equivalent isotropically radiated power (e.i.r.p.) is not more than that necessary for successful communication.

This device complies with Industry Canada licence-exempt RSS standard(s). Operation is subject to the following two conditions:

- (1) this device may not cause interference, and
- (2) this device must accept any interference, including interference that may cause undesired operation of the device.

Conformément à la réglementation d'Industrie Canada, le présent émetteur radio peut fonctionner avec une antenne d'un type et d'un gain maximal (ou inférieur) approuvé pour l'émetteur par Industrie Canada.

Dans le but de réduire les risques de brouillage radioélectrique à l'intention des autres utilisateurs, il faut choisir le type d'antenne et son gain de sorte que la puissance isotrope rayonnée équivalente (p.i.r.e.) ne dépasse pas l'intensité nécessaire à l'établissement d'une communication satisfaisante.

Le présent appareil est conforme aux CNR d'Industrie Canada applicables aux appareils radio exempts de licence. L'exploitation est autorisée aux deux conditions suivantes:

- (1) l'appareil ne doit pas produire de brouillage, et
- (2) l'utilisateur de l'appareil doit accepter tout brouillage radioélectrique subi, même si le brouillage est susceptible d'en compromettre le fonctionnement.

Directive 1999/5/EC

Hereby, WSAUD A/S declares that this FM+DEX is in compliance with the essential requirements and other relevant provisions of Directive 1999/5/EC.

A copy of the Declaration of Conformity according to 1999/5/EC can be found at:

<http://www.widex.com/doc>









Electrical and electronic equipment (EEE) contains materials, components and substances that can be hazardous and present a risk to human health and the environment when waste electrical and electronic equipment (WEEE) is not handled correctly.





Do not dispose of hearing aids, hearing aid accessories and batteries with ordinary household waste.





Hearing aids, batteries and hearing aid accessories should be disposed of at sites intended for waste electrical and electronic equipment, or given to your hearing care professional for safe disposal. Proper disposal helps to protect human health and the environment.





SYMBOLS

Symbols commonly used by WSAUD A/S in medical device labelling (labels/IFU/etc.)

Symbol	Title/Description
	Manufacturer The product is produced by the manufacturer whose name and address are stated next to the symbol. If appropriate, the date of manufacture may also be stated.
	Date of manufacture The date when the product was manufactured.
	Use-by date The date after which the product is not to be used.
	Batch code The product's batch code (lot or batch identification).

Symbol	Title/Description
	Catalogue number The product's catalogue (item) number.
	Serial number The product's serial number.*
	Keep away from sunlight The product must be protected from light sources and/or The product must be kept away from heat
	Keep dry The product must be protected from moisture and/or The product must be kept away from rain
	Lower limit of temperature The lowest temperature to which the product can be safely exposed.

Symbol	Title/Description
	Upper limit of temperature The highest temperature to which the product can be safely exposed.
	Temperature limits The highest and lowest temperatures to which the product can be safely exposed.
	Consult instructions for use The user instructions contain important cautionary information (warnings/precautions) and must be read before using the product.
	Caution/Warning Text marked with a caution/warning symbol must be read before using the product.

Symbol	Title/Description
	<p>WEEE mark “Not for general waste”</p> <p>When the product is to be discarded, it must be sent to a designated collection point for recycling and recovery.</p>
	<p>CE mark</p> <p>The product is in conformity with the requirements set out in European CE marking directives.</p>
	<p>Alert</p> <p>The product is identified by R&TTE Directive 1999/5/EC as an equipment Class 2 product with some restrictions on use in some CE member states.</p>
	<p>C-Tick mark</p> <p>The product complies with EMC and radio spectrum regulatory requirements for products supplied to the Australian or New Zealand market.</p>

Symbol	Title/Description
	Interference Electromagnetic interference may occur in the vicinity of the product.

*The six- or seven-digit number on the product is the serial number. Serial numbers may not always be preceded by **SN**



WSAUD A/S

Nymoellevej 6, DK-3540 Lyngby, Denmark
<https://global.widex.com>

Manual no.:
9 514 0198 001 #05
Issue:
2020-11

